

Flat Washers - Type B (Regular)

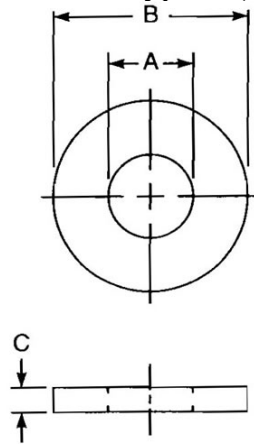

| DIMENSIONAL DATA | | |
|--|---|--|
| Type: Flat Washers - Type B (Regular) | Standard: ASME B18.21.1-2009 | Size: 5/16 |
| Nominal: 0.312 | A - Inside Diameter: 0.359 - 0.339 | B - Outside Diameter: 0.890 - 0.868 |
| C - Thickness: 0.071 - 0.056 | | |
| MATERIAL DATA | | |
| Typical Material: Silicon-Bronze (UNS C65100 or C65500) | Hardness: HRB 90 min. | |
| FINISH DATA | | |
| Finish Type: Plain | K factor (ref. DIN 946): 0.2 | RoHS/REACH Compliant: yes |
| Color: colorless | | |

